

# Pop-up Counter

## User Guide

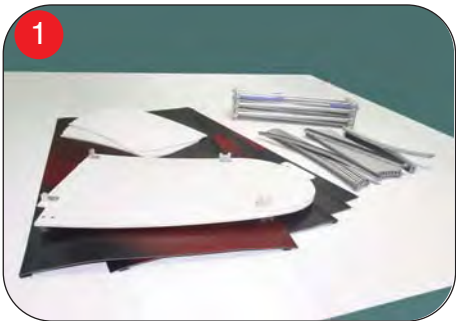

1. Components.



2. Stand frame as shown.

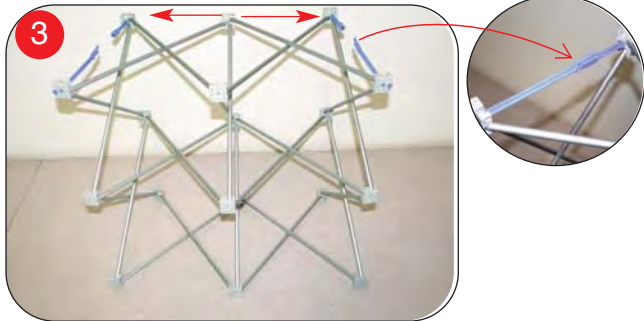

3. Extend frame and secure two locking bars.

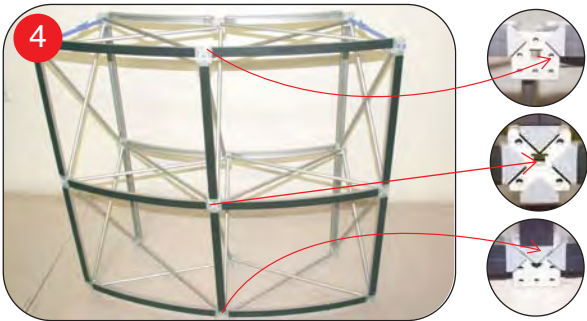

4. Attach magbars to both sides of frame. Note: all magbars attach to middle hole of hub, both horizontal and vertical.



5. Attach 1-piece graphic panel all around.

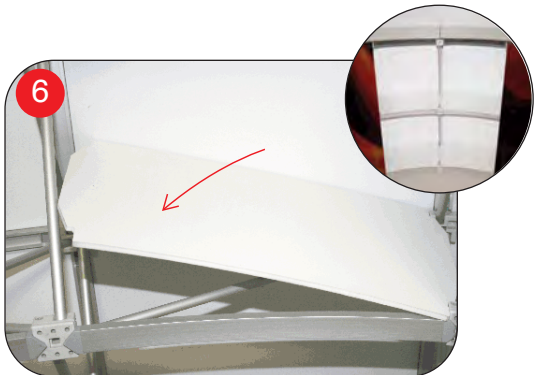

6. Insert internal shelves.

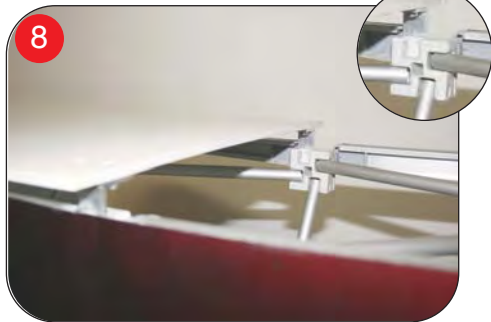

7-8. Install counter tops, inserting hubs securely into routed locations.



9. Your Counter is now ready for display.



Tops are now "beech".

System Components	Curved	Straight
Graphic Panel	1	1
Frame	1	1
Counter top	2	2
Internal Shelf	4	4
Outside Curve Magbar	6	-
Inside Curve Magbar	6	-
Straight Magbar	10	22